

CLASS 2 GRADE: 20-28 dB ATTENUATION

NOTES:

- WEIGHTS ARE APPROXIMATE WITH (2) ELEMENTS
- THIS EQUIPMENT SHALL BE SUPPORTED SUCH THAT NO MOMENTS OR FORCES ARE ON THE INLET AND OUTLET FLANGES
- ACCESS DOOR BOLTS: FULLY THREADED HEX HEAD CAP SCREWS - 5/8"-11 x 3", 304 SS ON STAINLESS STEEL UNITS AND GRADE 5 ZINC PLATED ON CARBON STEEL UNITS
- ACCESS DOOR GASKET: 1/8" THICK BY 1 1/2" WIDE VERMICULITE COATED CENTER SLOTTED (PSA) FLAT GASKET
- ELEMENT SEALING GASKET: INSWOOL 2300 COMPOSITE GASKET

PREMIUM OPTIONS:

- TRUNIONS (CUSTOMER TO SPECIFY SIZE, LOCATION AND ORIENTATION OFF THE INLET FLANGE).
- FLANGE SIDE ENTRY/OUTLET (CUSTOMER TO SPECIFY ORIENTATION - 45°, 90°, 180°, ETC WITH 0° ALWAYS ALIGNED WITH LOCATION OF THE HOUSING LID, LOOKING DOWN THE LONG AXIS OF THE CONVERTER, SPECIFY DEGREES OF FLANGE CENTERLINE AS VIEWED FROM THE INLET END.
- STAINLESS STEEL ASSEMBLIES WILL BE SUPPLIED WITH CARBON STEEL FLANGES AS STANDARD. STAINLESS STEEL FLANGES CAN BE SUBSTITUTED FOR AN ADDITIONAL FEE.
- EXTRA PORTS.
- FLANGE SIZE OTHER THAN EC STANDARD (NOTE: PRESSURE DROP (DP) SHOULD BE VERIFIED FOR ALL SMALLER FLANGE SIZE REQUESTS).

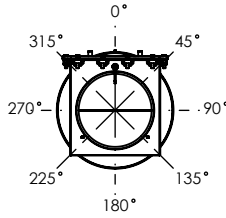

SIDE INLET/OUTLET ORIENTATION

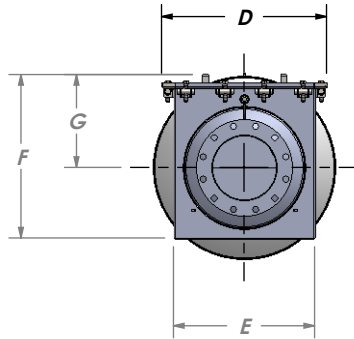

MODEL	WEIGHT (lbs.)	A (in.)	B (in.)	C (in.)	D (in.)	E (in.)	F (in.)	G (in.)	H(in.)	I (in.)	ACCESS DOOR GASKET (ft.)	ELEMENT SEALING GASKET P/N
EC-0800-02-C-XX	179	2" - 150#	2" - 150#	61.000	16.000	12.019	15.485	9.476	8.394	12.499	5	EG-EC0800
EC-0800-03-C-XX	202	3" - 150#	3" - 150#	64.000	16.000	12.019	15.485	9.476	8.394	14.499	5	EG-EC0800
EC-1000-02-C-XX	194	2" - 150#	2" - 150#	61.000	18.000	14.019	17.485	10.476	10.394	12.499	5	EG-EC1000
EC-1000-03-C-XX	218	3" - 150#	3" - 150#	64.000	18.000	14.019	17.485	10.476	10.394	14.499	5	EG-EC1000
EC-1200-03-C-XX	239	3" - 150#	3" - 150#	66.000	20.000	16.019	19.485	11.476	12.394	14.499	6	EG-EC1200
EC-1200-04-C-XX	264	4" - 150#	4" - 150#	66.000	20.000	16.019	19.485	11.476	12.394	16.499	6	EG-EC1200
EC-1200-05-C-XX	289	5" - 150#	5" - 150#	68.000	20.000	16.019	19.485	11.476	12.394	18.499	6	EG-EC1200
EC-1450-05-C-XX	315	5" - 150#	5" - 150#	67.000	22.500	18.519	22.735	13.476	16.394	18.499	6	EG-EC1450
EC-1450-06-C-XX	389	6" - 150#	6" - 150#	74.000	22.500	18.519	22.735	13.476	16.394	22.394	6	EG-EC1450
EC-1450-08-C-XX	511	8" - 150#	8" - 150#	88.000	22.500	18.519	22.735	13.476	16.394	26.394	6	EG-EC1450
EC-1950-06-C-XX	460	6" - 150#	6" - 150#	80.000	27.500	23.519	27.235	15.476	20.394	22.394	7	EG-EC1950
EC-1950-08-C-XX	582	8" - 150#	8" - 150#	94.000	27.500	23.519	27.235	15.476	20.394	26.394	7	EG-EC1950
EC-1950-10-C-XX	802	10 - 150#	10 - 150#	119.000	27.500	23.519	27.235	15.476	20.394	30.394	7	EG-EC1950
EC-2150-10-C-XX	927	10 - 150#	10 - 150#	118.000	30.000	25.625	29.563	16.750	22.500	30.394	7	EG-EC2150
EC-2150-12-C-XX	1168	12 - 150#	12 - 150#	128.000	30.000	25.625	29.563	16.750	22.500	36.394	7	EG-EC2150
EC-2150-14-C-XX	1263	14 - 150#	14 - 150#	139.000	30.000	25.625	29.563	16.750	22.500	36.394	7	EG-EC2150
EC-2350-10-C-XX	953	10 - 150#	10 - 150#	118.000	32.000	27.625	31.563	17.750	24.500	30.394	8	EG-EC2350
EC-2350-12-C-XX	1194	12 - 150#	12 - 150#	128.000	32.000	27.625	31.563	17.750	24.500	36.394	8	EG-EC2350
EC-2350-14-C-XX	1290	14 - 150#	14 - 150#	139.000	32.000	27.625	31.563	17.750	24.500	36.394	8	EG-EC2350
EC-2650-10-C-XX	987	10 - 150#	10 - 150#	116.000	35.000	30.625	34.063	18.750	26.500	30.394	8	EG-EC2650
EC-2650-12-C-XX	1228	12 - 150#	12 - 150#	127.000	35.000	30.625	34.063	18.750	26.500	36.394	8	EG-EC2650
EC-2650-14-C-XX	1324	14 - 150#	14 - 150#	138.000	35.000	30.625	34.063	18.750	26.500	36.394	8	EG-EC2650
EC-2850-12-C-XX	1260	12 - 150#	12 - 150#	127.000	37.000	32.625	36.063	19.750	28.500	36.394	9	EG-EC2850
EC-2850-14-C-XX	1356	14 - 150#	14 - 150#	138.000	37.000	32.625	36.063	19.750	28.500	36.394	9	EG-EC2850
EC-2850-16-C-XX	1700	16 - 150#	16 - 150#	158.000	37.000	32.625	36.063	19.750	28.500	42.394	9	EG-EC2850
EC-3025-14-C-XX	1386	14 - 150#	14 - 150#	138.000	38.750	34.375	37.938	20.750	30.500	36.394	9	EG-EC3025
EC-3025-16-C-XX	1730	16 - 150#	16 - 150#	158.000	38.750	34.375	37.938	20.750	30.500	42.394	9	EG-EC3025
EC-3025-18-C-XX	2122	18 - 150#	18 - 150#	175.000	38.750	34.375	37.938	20.750	30.500	48.394	9	EG-EC3025
EC-3025-20-C-XX	2324	20 - 150#	20 - 150#	198.000	38.750	34.375	37.938	20.750	30.500	48.394	9	EG-EC3025
EC-3350-16-C-XX	1848	16 - 150#	16 - 150#	168.000	42.000	37.625	41.563	22.750	34.500	42.394	9	EG-EC3350
EC-3350-18-C-XX	2240	18 - 150#	18 - 150#	185.000	42.000	37.625	41.563	22.750	34.500	48.394	9	EG-EC3350
EC-3350-20-C-XX	2442	20 - 150#	20 - 150#	208.000	42.000	37.625	41.563	22.750	34.500	48.394	9	EG-EC3350
EC-3550-16-C-XX	1880	16 - 150#	16 - 150#	167.000	44.000	39.625	43.563	23.750	36.500	42.394	10	EG-EC3550
EC-3550-18-C-XX	2272	18 - 150#	18 - 150#	184.000	44.000	39.625	43.563	23.750	36.500	48.394	10	EG-EC3550
EC-3550-20-C-XX	2474	20 - 150#	20 - 150#	208.000	44.000	39.625	43.563	23.750	36.500	48.394	10	EG-EC3550

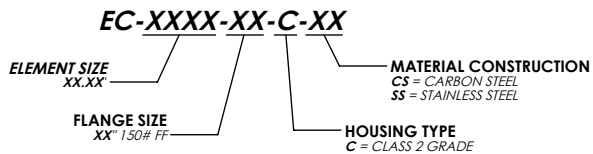
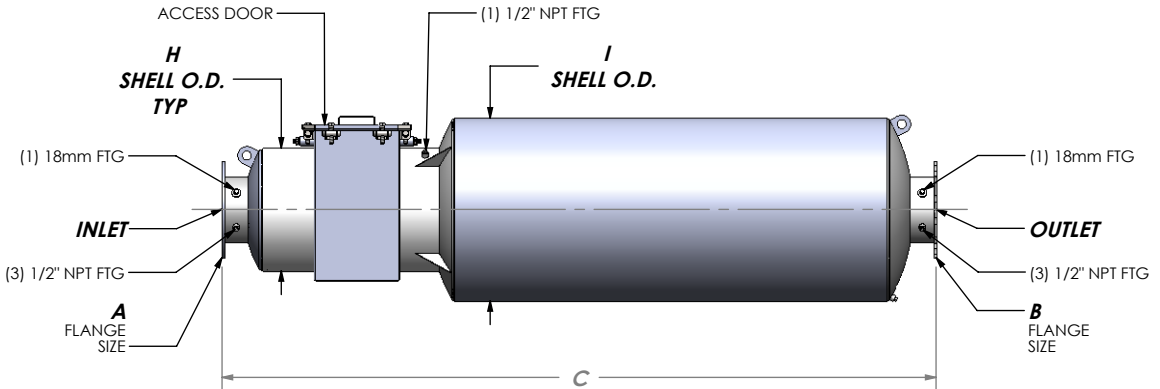

DRAWN	JU	DATE	5/20/2013
ENGINEER	-	DATE	-
APPROVED	-	DATE	-

PROPRIETARY AND CONFIDENTIAL

THIS DRAWING CONTAINS PROPRIETARY INFORMATION WHICH IS TO BE HELD CONFIDENTIAL AND MAY NOT BE REPRODUCED OR DISCLOSED TO OTHERS WITHOUT THE PRIOR WRITTEN CONSENT OF EMERACHEM OR A DULY AUTHORIZED REPRESENTATIVE THEREOF.



DRAWING EC-XXXX-XX-C-XX SD Rev.3 REV 3

CLASS 2 GRADE COMBO SIZING DRAWING